

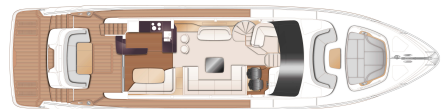

2022
PRINCESS Y72
UNDER CONSTRUCTION • Y72024

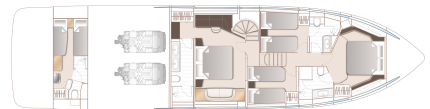

LOCATION PLYMOUTH, ENGLAND

2X MAN V12 (2X 1650 HP)
MAX SPEED, CA 32 KN
LENGTH 21.77 M X BEAM 5.52 M
10 BERTHS • 5 CABINS • 4 HEADS

SOLD

Princess Yachts West Sweden
+46 (0) 304 390 90
princessyachts.se

Princess Yachts Norway
+47 55 52 50 30 / +47 66 76 08 70
princessyachts.no

Princess Yachts Denmark
+45 70 26 84 84
princessyachts.dk

PROPULSION

Engines	2x MAN V12
Power	2x 1650 hp
Speed, ca	32 kn
Type	Inboard
Drive Type	Shaft
Fuel Type	Diesel

DIMENSIONS

Length	21.77 m
Beam	5.52 m
Draft, ca	1.72 m
Weight, ca	51800 kg
Fuel	2x 1375 L
Water	1x 608 L
Septic	1x 315 L

OTHER DETAILS

Manufacturer	Princess Yachts Limited
Designer	Olesinski
Boat Category	Power
Hull Shape	Planing
Material	Fibreglass
El. Circuit	24 V
Berths	10
Cabins	5
Heads	4

We will deliver a new Princess Y72 in 2022. Photos are of a sister boat

The details of this vessel is written in good faith, but we cannot guarantee or warrant the accuracy of this information nor warrant the condition of the vessel. A buyer, or his surveyor, should investigate such details as the buyer desires validated. This vessel is offered subject to prior sale, price change, or withdrawal without notice.

Princess Yachts West Sweden
+46 (0) 304 390 90
princessyachts.se

Princess Yachts Norway
+47 55 52 50 30 / +47 66 76 08 70
princessyachts.no

Princess Yachts Denmark
+45 70 26 84 84
princessyachts.dk