



2025

PRINCESS F65

UNDER CONSTRUCTION • F65047

LOCATION PLYMOUTH, ENGLAND

2X MAN V8 (2X 1200HP) - H
MAX SPEED, CA KN
LENGTH 20.3 M X BEAM 5.1 M
5 CABINS • 4 HEADS

SOLD

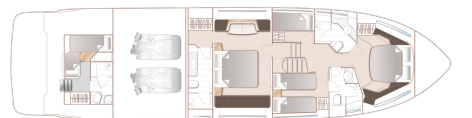
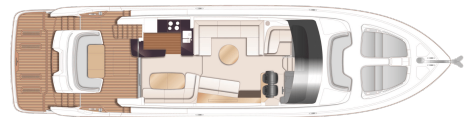
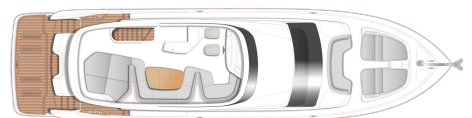

Princess Yachts West Sweden
+46 (0) 304 390 90
princessyachts.se

Princess Yachts Norway
+47 66 76 08 70
princessyachts.no

Princess Yachts Denmark
+45 70 26 84 84
princessyachts.dk

PROPULSION

Engines	2x MAN V8
Power	2x 1200 hp
Type	Inboard
Drive Type	Shaft
Fuel Type	diesel

DIMENSIONS

Length	20.3 m
Beam	5.1 m
Draft, ca	1.63 m
Weight, ca	40177 kg
Fuel	2x 4100 L
Water	873 L
Septic	1x272 L

OTHER DETAILS

Manufacturer	Princess Yachts Limited
Designer	Olesinski
Boat Category	Power
Hull Shape	Planing
Material	Fibreglass
El. Circuit	24 V
Cabins	5
Heads	4

We have a new Princess F65 available for a Scandinavian owner for spring 2025.

The details of this vessel is written in good faith, but we cannot guarantee or warrant the accuracy of this information nor warrant the condition of the vessel. A buyer, or his surveyor, should investigate such details as the buyer desires validated. This vessel is offered subject to prior sale, price change, or withdrawal without notice.

Princess Yachts West Sweden
+46 (0) 304 390 90
princessyachts.se

Princess Yachts Norway
+47 66 76 08 70
princessyachts.no

Princess Yachts Denmark
+45 70 26 84 84
princessyachts.dk